

INSTRUCTION MANUAL

S460W 4" x 60" Wet Belt Sander

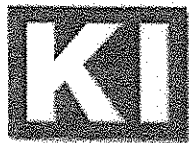
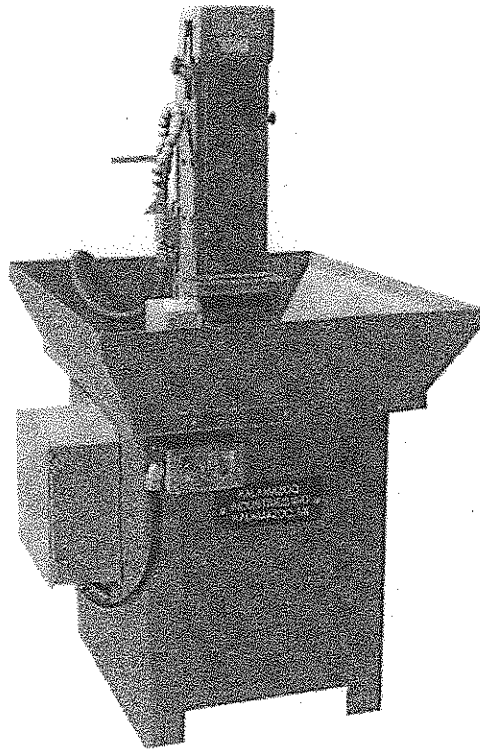

**KALAMAZOO
INDUSTRIES, INC.**

6856 East K Avenue
Kalamazoo, MI 49048

269-382-2050 PH

269-382-0790 FAX

www.kalamazooindustries.com

WARRANTY

All products are guaranteed for a period of one year to the original purchaser, against defects in material workmanship under normal use. Electric motors are warranted by the motor manufacturer and will be repaired by the nearest motor repair station. If non-repairable, they will be replaced by Kalamazoo Industries. Please call for instructions 269-382-2050.

RETURN POLICY

Authorization must be obtained before returning merchandise. Please call our customer service department for a return authorization number at 269-382-2050. Please include with your return a copy of your invoice or packing slip. Materials must be sent back prepaid. (Unless otherwise indicated). All returns will be subject to a 10% restocking charge. No returns will be accepted after one year of invoice date.

BELT SANDER SAFETY

- READ THE OPERATING INSTRUCTIONS BEFORE RUNNING MACHINE.
- ALWAYS WEAR SAFETY GLASSES OR A FULL FACE SHIELD FOR PROTECTION.
- KEEPS HANDS CLEAR OF THE SANDING AREA.
- NEVER WEAR GLOVES OR LOOSE FITTING CLOTHES WHEN OPERATING THIS MACHINE.
- ALWAYS KEEP HAIR TIED BACK OR COVERED.
- LET MACHINE ROTATION COME TO A FULL STOP BEFORE CHANGING BELT.
- KEEP SAFETY GUARDS IN PLACE. DO NOT ALTER GUARDS OR MACHINE IN ANY WAY. ANY ALTERATIONS TO GUARDS OR MACHINE COULD CAUSE SERIOUS INJURY.
- ALL BELT SANDERS SHOULD BE OPERATED IN A WELL-VENTILATED AREA. THE DUST CREATED WHEN SOME MATERIALS ARE SANDED CAN BE HARMFUL. DUST MASKS ARE RECOMMENDED AS A PRACTICAL MEANS OF MINIMIZING DUST INHALATION. FUMES FROM OTHER SOURCES CAN ALSO CAUSE FIRES WHEN IN CONTACT WITH SANDING SPARKS.
- SPARKS CREATED BY SANDING SHOULD BE DIRECTED DOWNWARD AND AWAY FROM THE FACE AND BODY. DO NOT GRIND NEAR FLAMMABLE MATERIAL.
- ELECTRIC SANDING MACHINES ARE NOT INTENDED FOR USE IN OR NEAR WATER. THIS INCLUDES AN OPERATOR STANDING ON A WET FLOOR OR WORKING AROUND CONTAINERS OF WATER OR OTHER CONDUCTIVE LIQUIDS.

KALAMAZOO INDUSTRIES, INC.
6856 East K Avenue
Kalamazoo, MI 49048
269-382-2050 PH
269-382-0790 FAX
www.kalamazooindustries.com

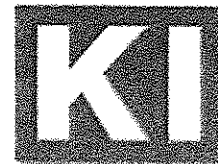

Made in USA

Basic Operation: Model S460W Wet Belt Sander

Sanding belt size 4"x60"

3HP, 1ph 110 or 220 volt / 3HP, 3ph, 220 or 440 volt

NOTE: Disconnect power before servicing machine.

Belt Changing - Use lever #3 to release sanding belt tension. Pull lever to compress spring, remove and replace sanding belt. Push lever back to tension sanding belt.

Belt Tracking - Use tracking knob #19 to track or "center" the sanding belt. Rotate sanding belt by hand to be sure of sanding belt centering. When sanding belt remains centered on the steel platen (#6) tracking is complete. Connect AC power and "jog" on/off switch to be sure sanding belt stays in the center of the platen and is tracked correctly.

Platen - Steel plate of "platen" is behind the sanding belt. It will wear over time and can be flipped over to use a new surface area. Remove cap screws on the platen and flip for new surface area.

Work Table - Always keep work table within 1/8" of sanding belt. Too large a gap will allow work pieces and fingers to get pinched. **CAUTION: DO NOT WEAR GLOVES!!!**

Maintenance - Keep machine clean. Flip or rotate platen when impressions wear into it. No grease is required. All bearings are sealed for life.

Trouble shooting - Basic machine needs very little maintenance other than tracking the sanding belt. If sanding belt does not stay tracked typically the drive pulley (#27) has lost its "crown". The drive pulley is tapered down from the center out to each edge slightly. This makes the sanding belt stay in the center or "tracked".

Safety - Always wear safety glasses. Do not wear gloves.

ITEM	PART NO	DESCRIPTION	
1		5/16-18x2 STOVER BOLT	
2	700-022	TENSION SHAFT IDLER YOKE	
3	455-004	TENSION RELEASE LEVER	
4	697-024	TENSION SPRING	
5		FLAT HEAD ALLEN SCREW	
6	563-014	PLATEN	
7	291-018	FRAME SANDER	
8	123-003	COLLAR	
9	960-002	YOKE	
10	5100-50	RETAINING RING	
11	560-006	IDLER PULLEY W/BEARINGS	
	560-006IPA	IDLER PULLEY ASSY (OPTIONAL)	
12	701-008	IDLER SPINDLE	
13	710-415	PUSHBUTTON ENCLOSURE	
	710-031	GREEN BUTTON	
	710-032	RED STOP BUTTON	
14	701-039	DRIVE SPINDLE-S460W	
15	560-052	MOTOR SHEEVE 2/3V265JA	
	049-020	MOTOR BUSHING JAX5/8	
16		SPLASH GUARD	
17		5/16-18x1-1/2 H.H.C.S.	
18		5/16 LOCK WASHER	
19		441-014	KNOB
20	697-017	SPRING	
21		WASHER	
22	291-028	FRAME & DOOR ASSY	
23	698-011	STUD, 3/8x6-1/2	
24	441-017	TRACKING KNOB	
25	044-007	K10 BEARING	
26	386-024	BEARING HOUSING-S460W	
27	580-044	DRIVE WHEEL-S460W	
28	044-001	K12 BEARING	
29		12W STAND	
30	486-006	35P35-5560 3HP, 1PH S460W	
31	486-007	35P33-5561 3HP, 3PH S460W	
		1-1/2" PVC PIPE	
32	710-425	12X12 ENCLOSURE BOX	
	710-426	12X12 PANEL	
33	577-001	1 PHASE PUMP MOTOR	
	577-002	3 PHASE PUMP MOTOR	
34	716-011	COOLANT TANK	
35	560-051	SPINDLE SHEEVE 2/3V365SH	
36	049-019	SPINDLE BUSHING SHX5/8	
37	829-034	WORK TABLE	
38	051-006	3V375 V-BELT (2REQ)	
		1/2-13X1-1/2 S.H.C.S.	
39	342-077	GUARD, UPPER	
40	048-019	IDLER ADJUSTING BAR	



6856 East K Avenue
 Kalamazoo, MI 49048
 269-382-2050 PH
 269-382-0790 FAX
 www.kalamazooindustries.com

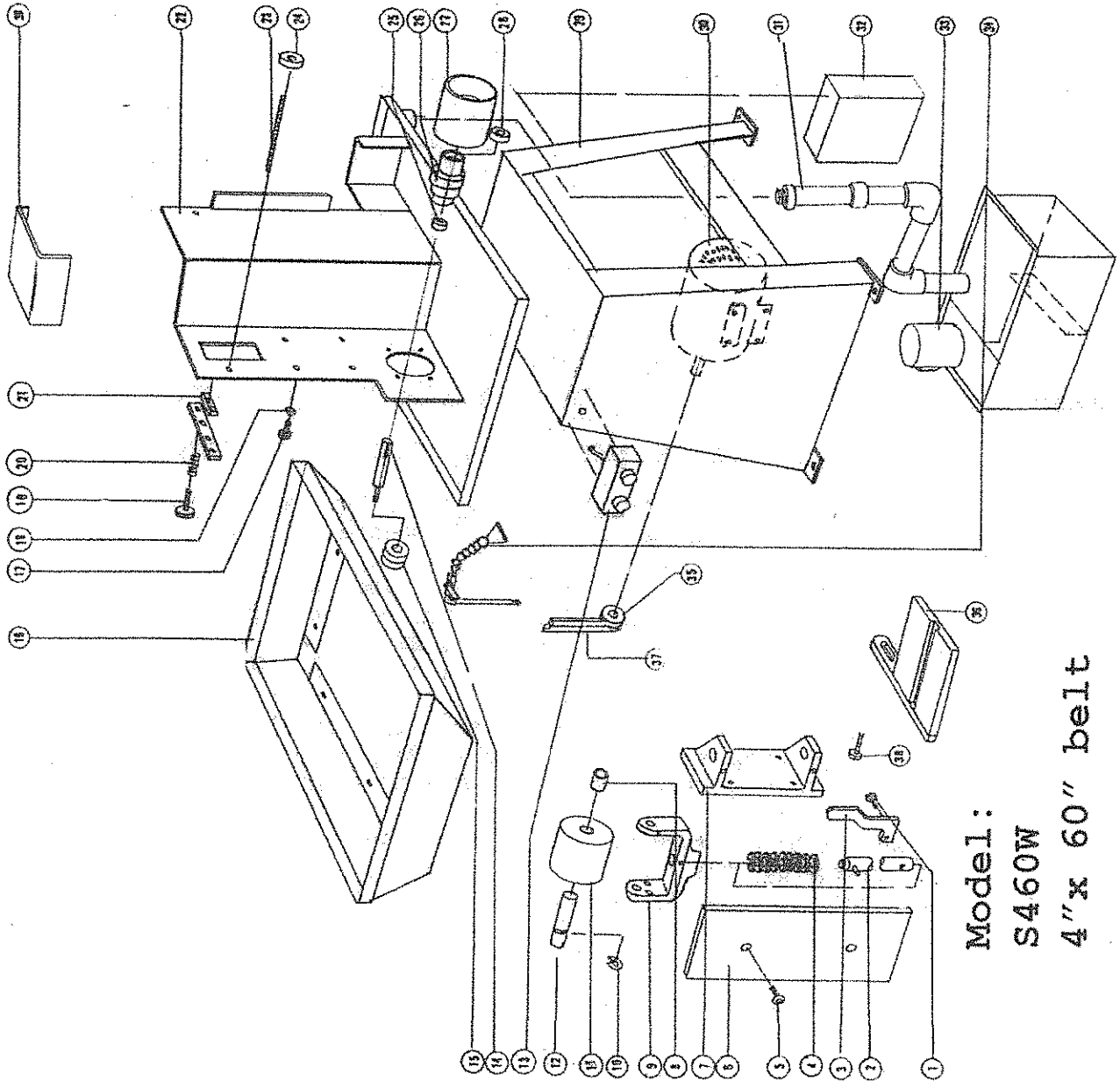

Model:
 S460W
 4" x 60" belt