

SPH Inox

Stainless Steel "Hybrid" Drill Chucks

- Combines the accuracy of a keyless chuck and the tightening torque of a keyed chuck:
 - **Used as a Keyless chuck.** Self-tightening mechanism automatically increases the clamping forces in proportion to the increase in torque during the drilling operation. This prevents tool slippage in clockwise rotation only.
 - **Used as a Keyed chuck.** Tightening force is 2 times more than a conventional keyed chuck, allowing the most demanding drilling operation in any rotation direction of the drill or surgical tool: clockwise, counterclockwise or oscillatory
- Specially designed for medical and veterinary surgical instruments
- All components are free of sharp edges : Excellent choice for use when operating with rubber gloves
- Manufactured in stainless steel series 300 and 400
- Undergo passivation processes to prevent corrosion
- Resistant to autoclaving
- All chucks are identified with a lot number for traceability according to ISO 13485
- With thru hole for insertion of drills, reamers, pins and other surgical tools used in the medical field

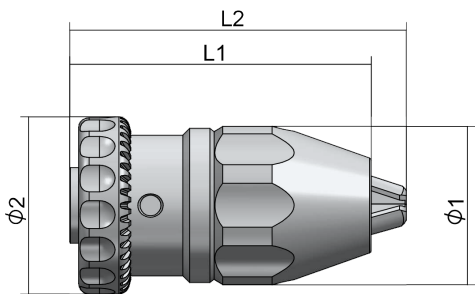

PART #	MODEL #	CAPACITY RANGE		MOUNT	KEY	Ø THRU HOLE		Ø1		L1		L2		Ø2		WEIGHT	
		inches	millimeters			in.	mm	in.	mm	in.	mm	in.	mm	in.	mm	lbs	gram
PHI031208	SPH-03 J0 FGE			J0													
PHI030908	SPH-03 R3/8 FGE	.012 - .125	0.3 - 3	3/8-24	K0T	0.12	3.2	1.06	27	1.85	47	2.00	51	1.14	29	0.29	130
PHI031808	SPH-03 R5/16 FGE			5/16-24													
PHI070410	SPH-07 J1 FGE-C			J1													
PHI070910	SPH-07 R3/8 FGE-C	.012 - .291	0.3 - 7.4	3/8-24	K1T	0.20	5.3	1.26	32	2.28	58	2.56	65	1.34	34	0.50	225